

PARK 16HST, 18HST

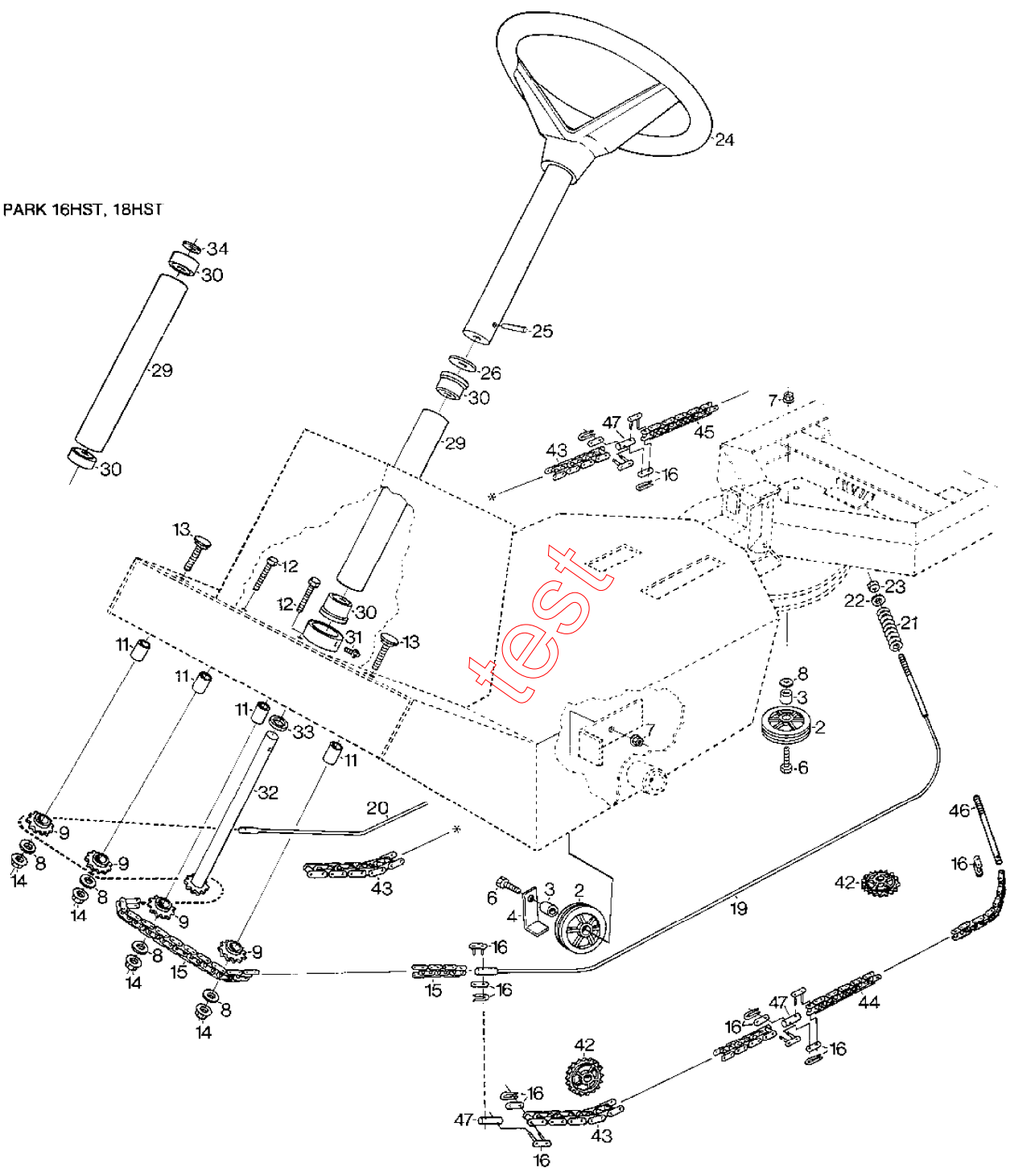

Section: PARK STEERING

| Pos. | Quantity | Spare part No | Description | Kit | Notes | New |
|------|----------|---------------|--------------|---------------------|--------------------|-----|
| | 1258 | 1358 | 1458 | 1818 | | |
| | 1442 | 1443 | 1446 | 1448 | | |
| 2 | 2 | 2 | 1134-9025-01 | Steering pulley-kit | Sats 2 st/kit of 2 | |
| 3 | 3 | 3 | 1134-0041-01 | Bushing | | |
| 4 | 2 | 2 | 1134-3022-01 | Cable holder | | |
| 6 | 3 | 3 | 9997-1030-16 | Screw | | |
| 7 | 3 | 3 | 9739-1031-22 | Nut | | |
| 8 | 5 | 5 | 9699-0035-02 | Flat washer | | |
| 9 | 4 | 4 | 1134-2816-01 | Sprocket | | |
| 11 | 4 | 4 | 1134-0041-02 | Idler wheel bush | | |
| 12 | 2 | 2 | 9997-1040-12 | Screw | | |
| 13 | 2 | 2 | 9897-1040-12 | Screw | | |
| 14 | 4 | 4 | 9739-1031-22 | Nut | | |
| 15 | 1 | 1 | 1134-2820-01 | Chain w/o lock | | |
| 16 | 2 | 2 | 1134-2824-01 | Chain lock | | |
| 19 | 1 | 1 | 1134-2817-01 | Steering cable-LH | L = 939 mm | |
| 20 | 1 | 1 | 1134-2817-02 | Steering cable-RH | L = 990 mm | |
| 21 | 2 | 2 | 1134-2818-01 | Spring | | |
| 22 | 2 | 2 | 9699-0090-02 | Flat washer | | |
| 23 | 2 | 2 | 9747-0831-02 | Lock nut | | |
| 24 | 1 | 1 | 1134-1966-03 | Steering wheel | | |
| 25 | 1 | 1 | 9595-0262-00 | Locating pin | | |
| 26 | 1 | 1 | 9699-0103-02 | Flat washer | 0.5 mm | |
| 26 | 1 | 1 | 9699-0114-02 | Flat washer | 1.0 mm | |
| 29 | 1 | 1 | 1134-1305-03 | Steering column-low | | |
| 29 | | 1 | 1134-3085-01 | Steering column-low | | |
| 30 | 2 | 2 | 1134-1901-01 | Bearing | | |
| 30 | | 2 | 9549-0017-00 | Ball bearing | | |
| 31 | 2 | 2 | 9942-0612-16 | Screw | | |
| 32 | 1 | 1 | 1134-2821-01 | Steering rod | | |
| 32 | | 1 | 1134-3084-01 | Steering rod | | |
| 33 | | 1 | 1134-2837-02 | Spacer | | |
| 33 | 1 | 1 | 1134-2837-01 | Spacer | | |
| 34 | | 1 | 9695-0011-00 | Washer | | |
| 42 | | 3 | 1134-3547-01 | Sprocket | | |
| 43 | | 2 | 1134-2820-02 | Chain | 41 länk/link | |
| 44 | | 1 | 1134-2820-04 | Chain | 41 länk/link | |
| 45 | | 1 | 1134-2820-02 | Chain | 45 länk/link | |
| 46 | | 2 | 1134-3550-01 | End nipple | | |
| 47 | | 4 | 1134-3565-01 | Connection nipple | | |